



## Replacement

### **CAUTION**

Put on gloves to protect your hands.

### **Information**

- Use a plastic panel removal tool to remove interior trim pieces without marring the surface.
- Take care not to bend or scratch the trim and panels.

1. Remove the front seat.  
(Refer to Front Seat - "Front Seat Assembly")
2. Remove the rear seat.  
(Refer to Rear Seat - "Rear Seat Assembly")
3. Separate the pillar trim and then remove the front pillar trim (A) by pushing the mounting clip in the direction of the arrow.

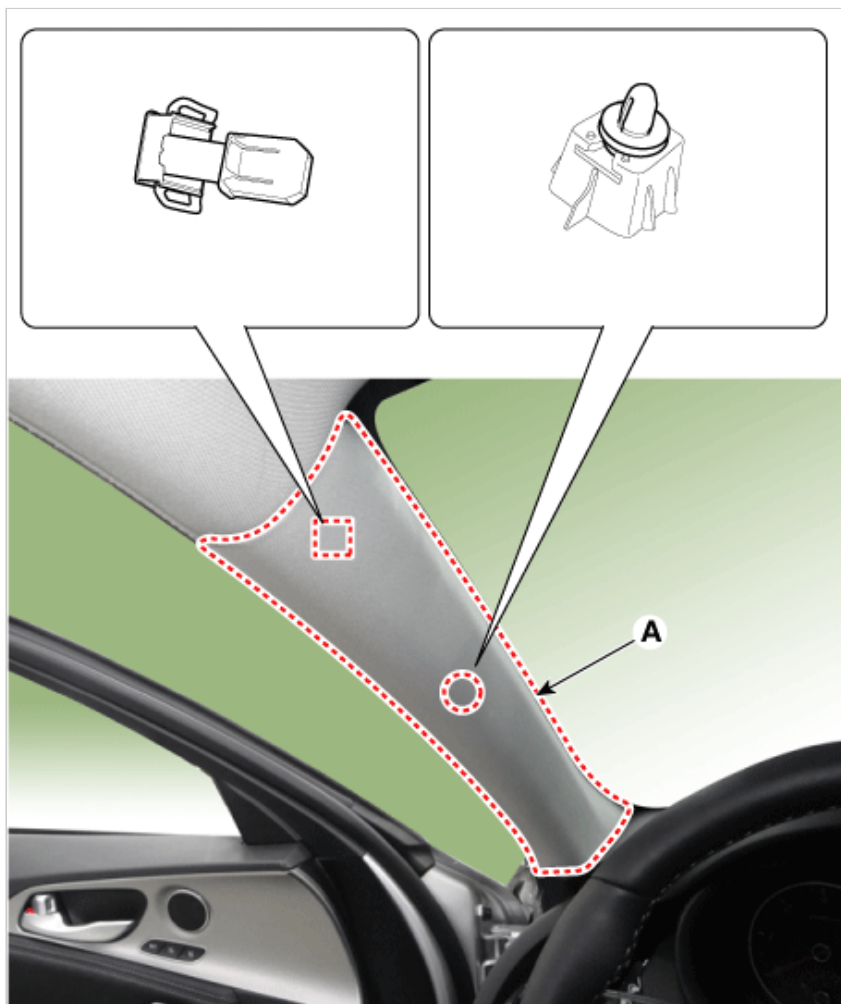

4. Remove the front door scuff trim (A) by using a remover.

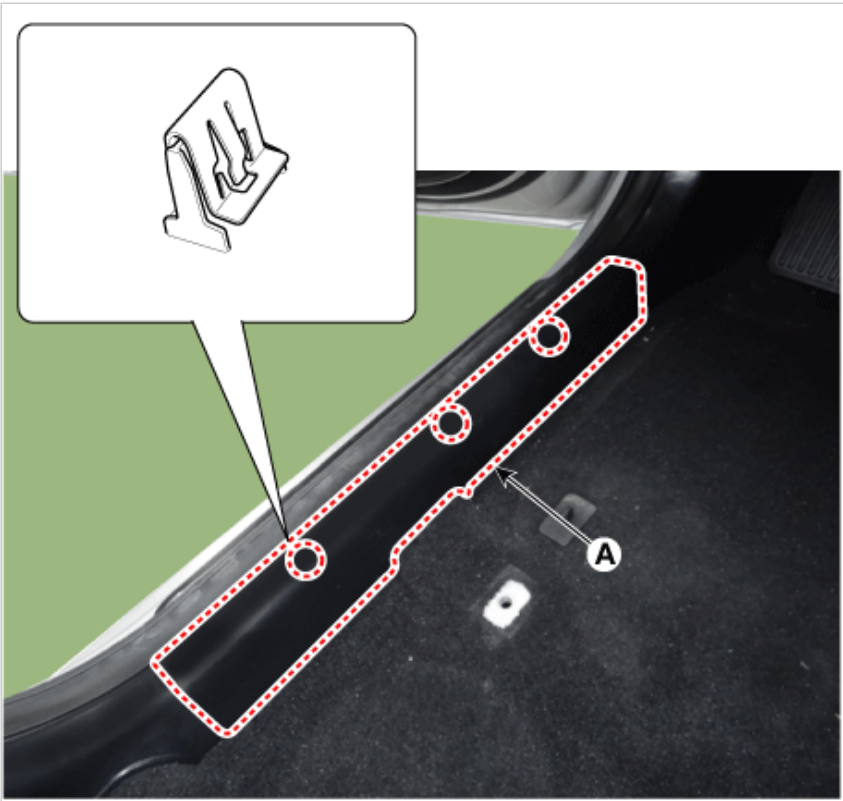

5. Remove the rear door scuff trim (A) after removing the mounting clip.

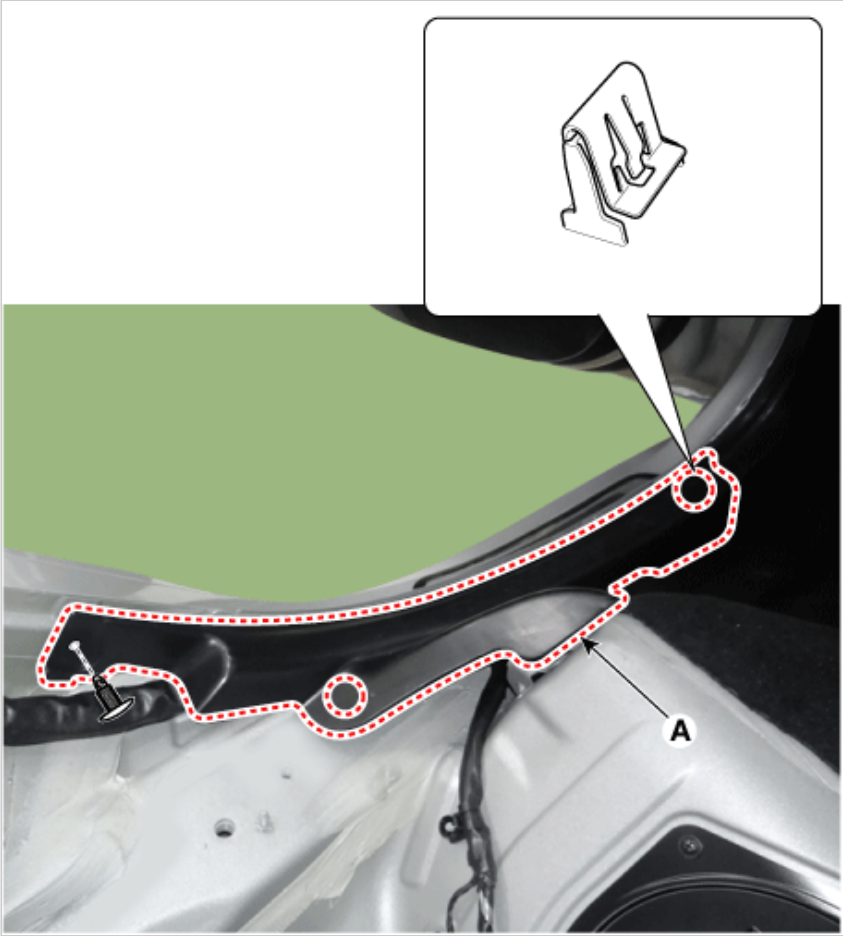

6. Remove the seat belt (B) from the EFD system (A) by using the SST (0K888-D4200).

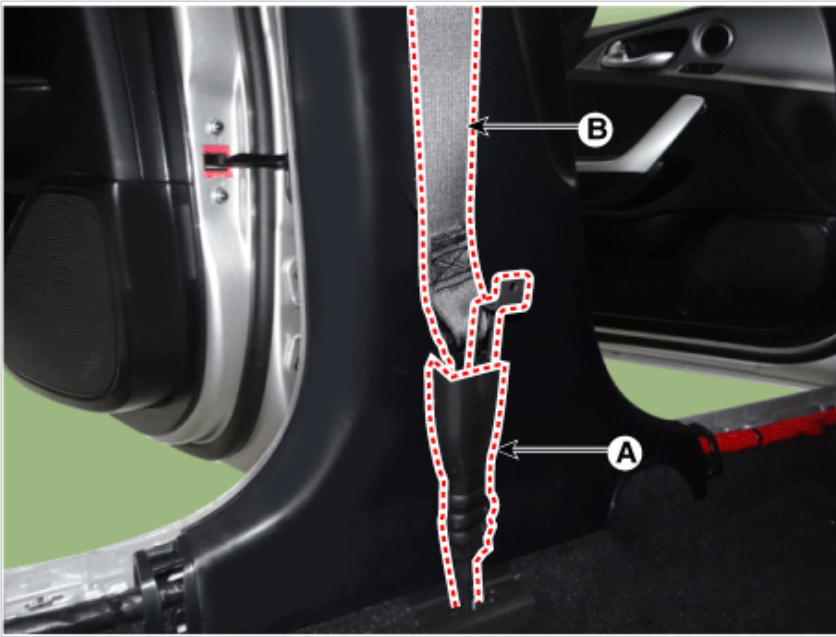

7. Remove the center pillar lower trim (A).



8. Remove the center pillar upper trim (A).

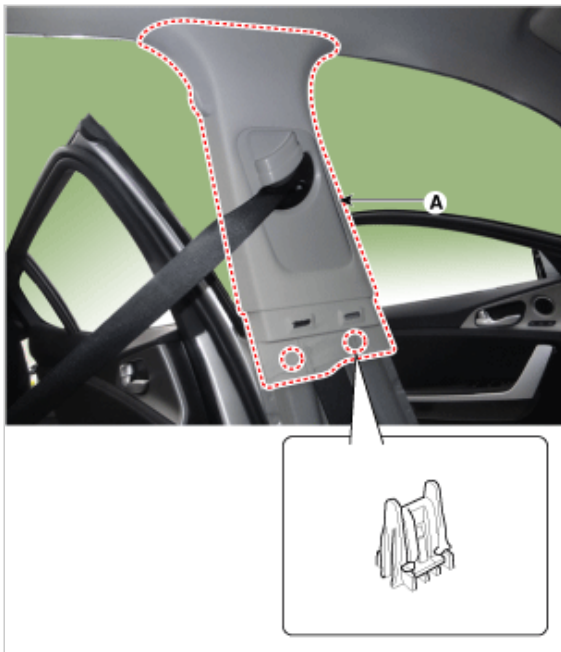

9. Remove the luggage covering mat(A).

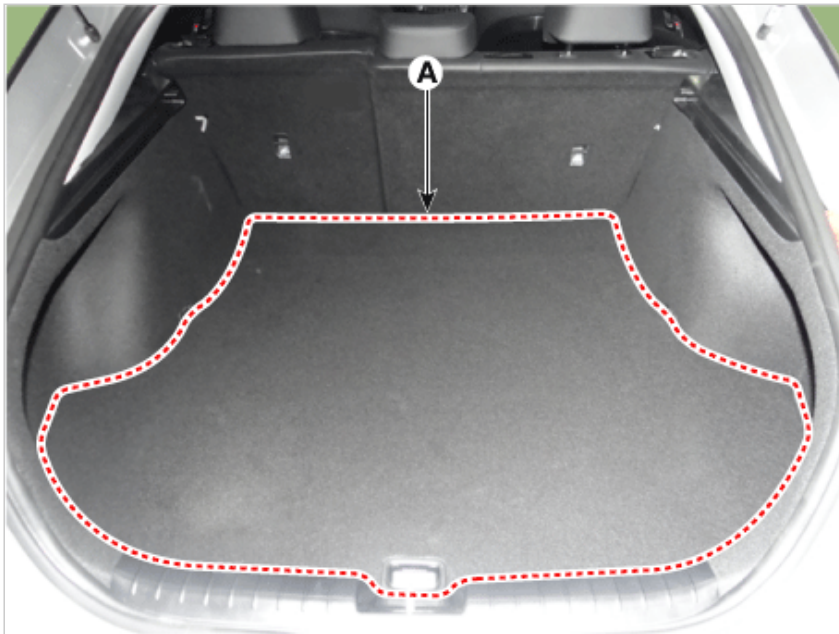

10. Remove the center tray (A).



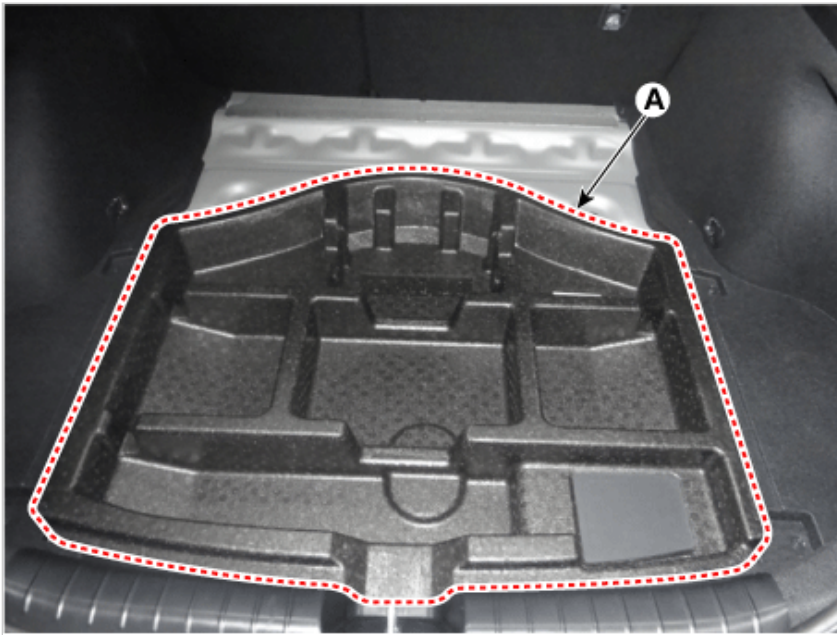

11. Remove the rear transverse trim (A).

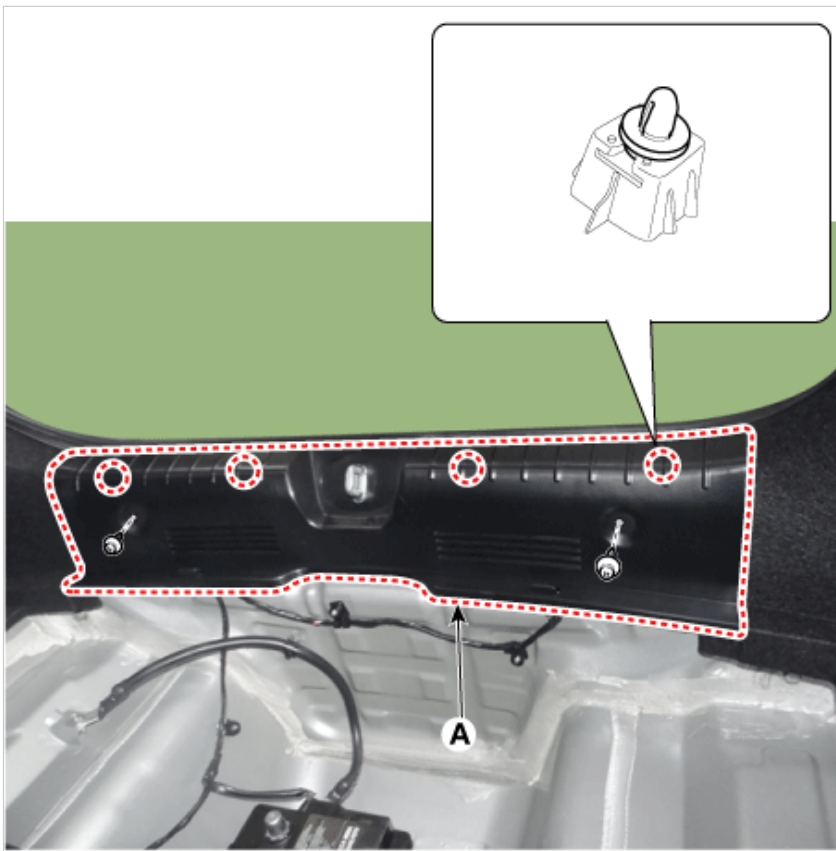

12. Separate the luggage side trim (A) after loosening the mounting screws.

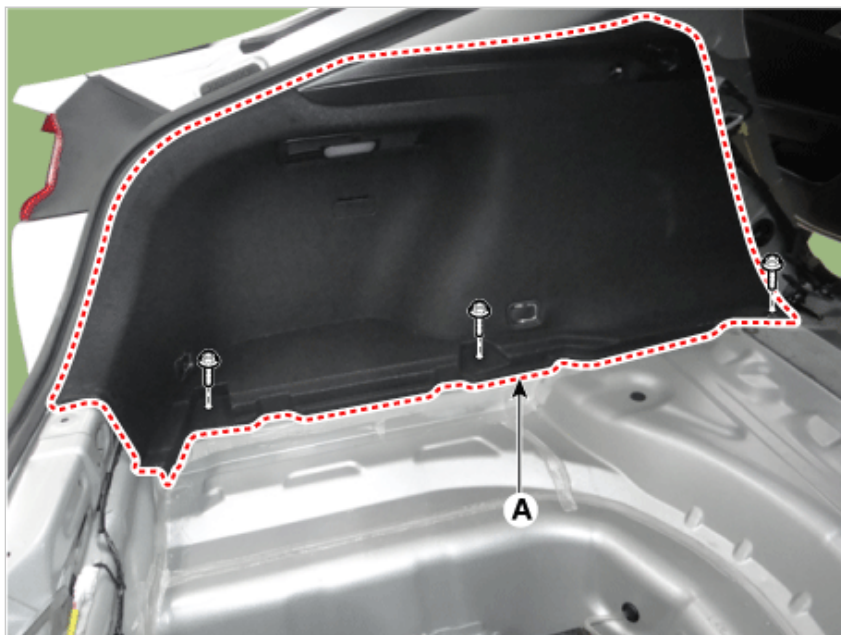

13. Remove the luggage side trim after disconnecting the luggage lamp connector (A).



14. Remove the rear pillar trim (A).

**Information**

Once the trim has been removed, replace the clip (B) with a new one.

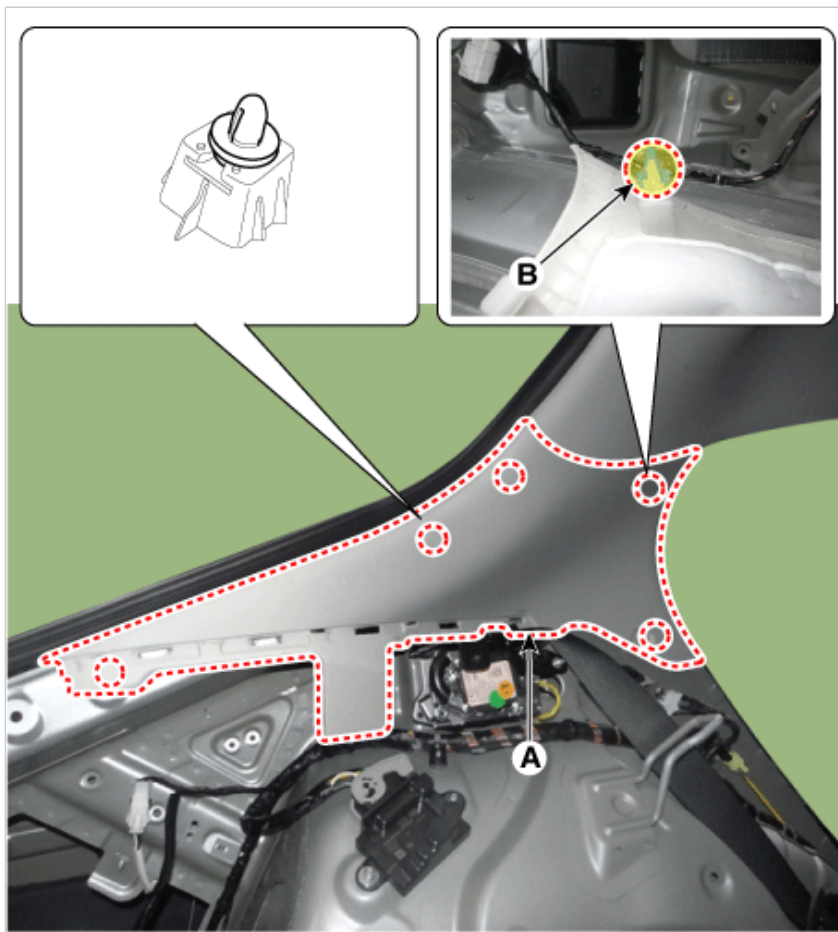

15. Separate the overhead console lamp (A) after loosening the mounting screws.

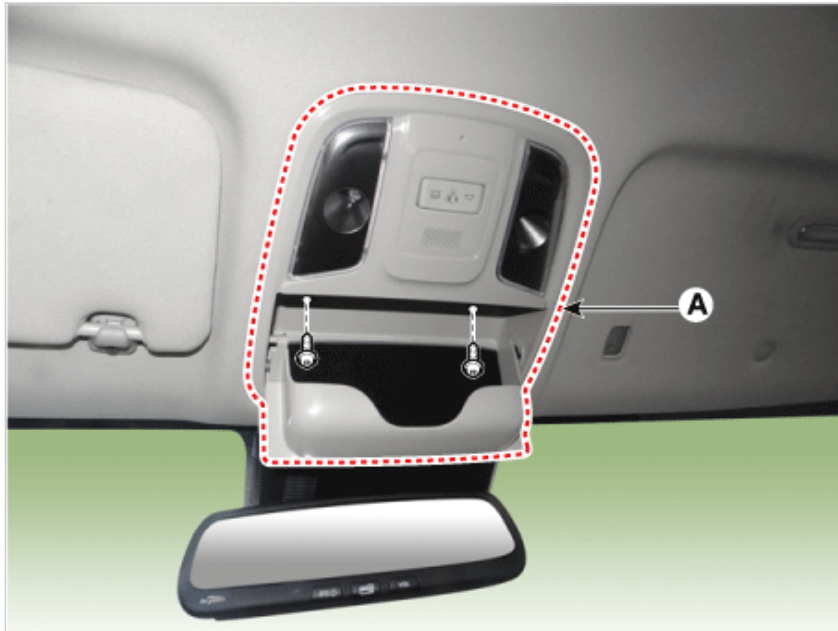

16. Remove the overhead console lamp after disconnect the connectors (A).



17. Separate the sunvisor cap (A).

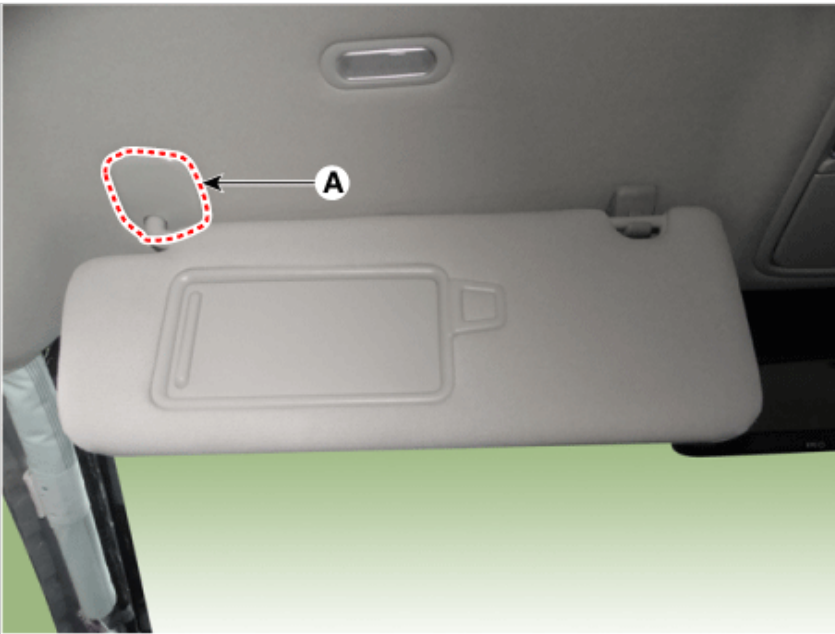

18. Separate the sunvisor (A) after loosening the mounting screw.



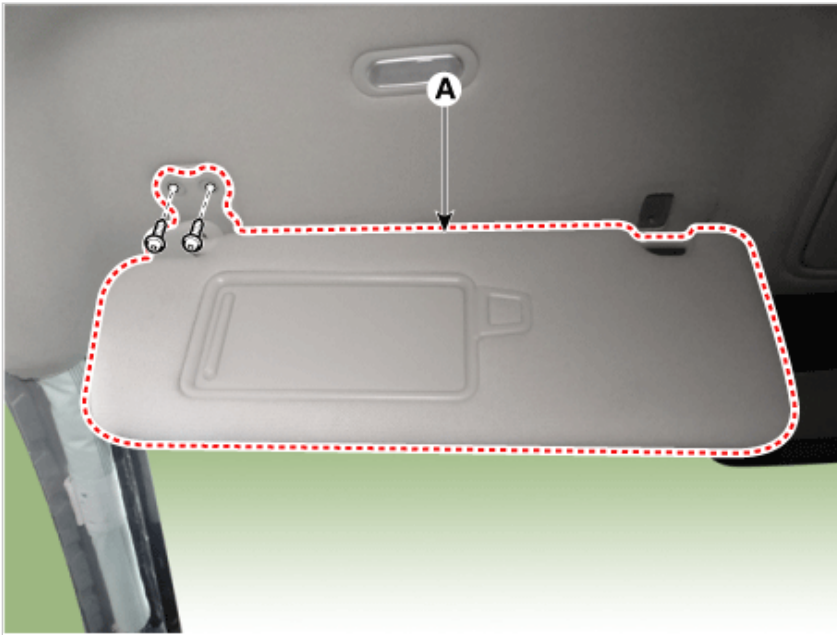

19. Remove the sunvisor after disconnect the connector (A).

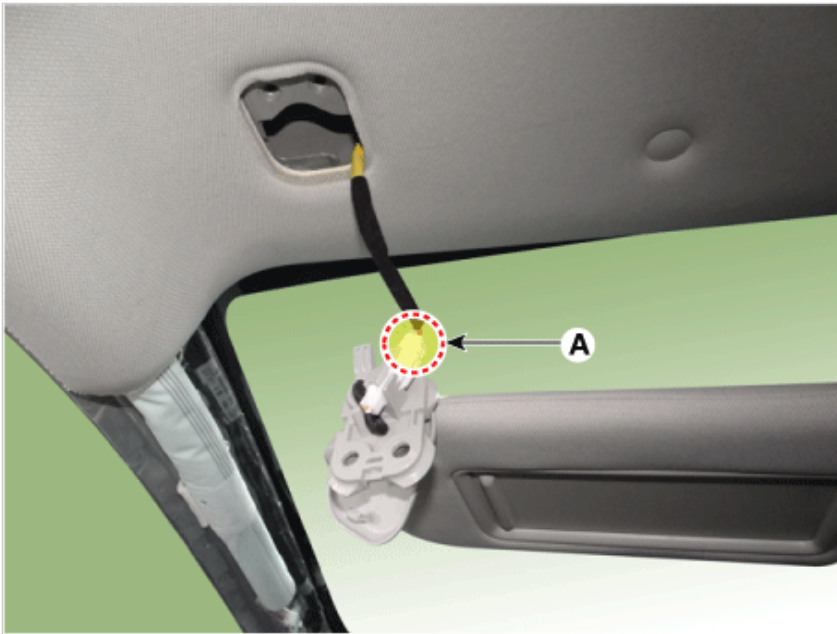

20. Remove the retainer (A) after loosening the mounting screw.

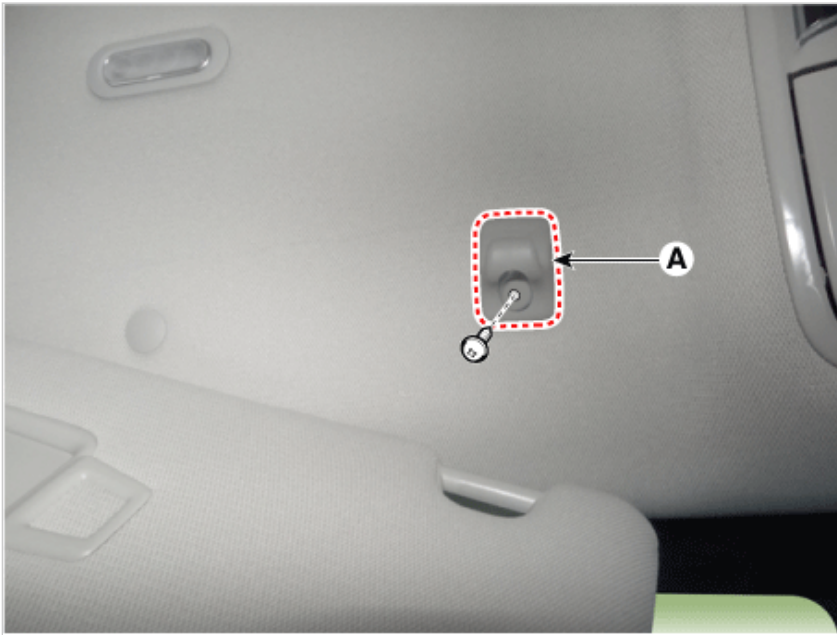

21. Remove the rain sensor cover (A) by using a remover.

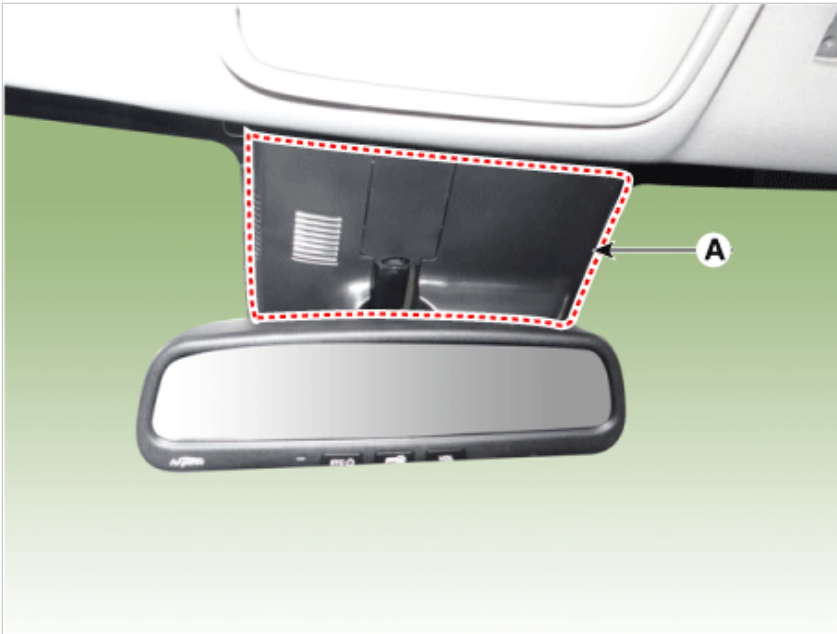

22. Disconnect the auto defogger sensor, ECM mirror sensor, LDWS (C) connectors.

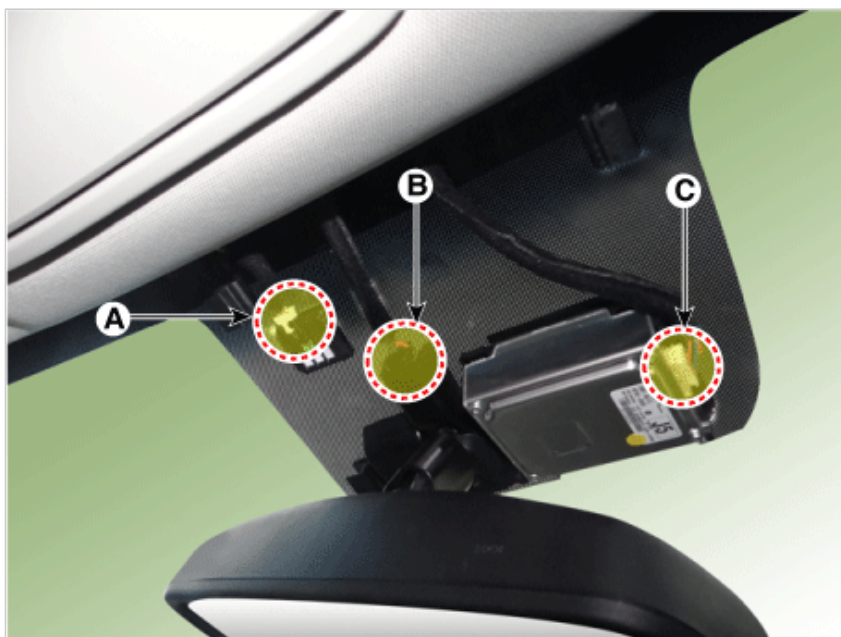

23. Remove the room lamp lens (A) by using a remover.



24. Separate the room lamp (A) after loosening the mounting screws.

#### NOTICE

- When removing the room lamp, be careful of the direction in which the tool is inserted (B).
- When inserting the tool in the opposite direction, take caution as the room lamp may be damaged.

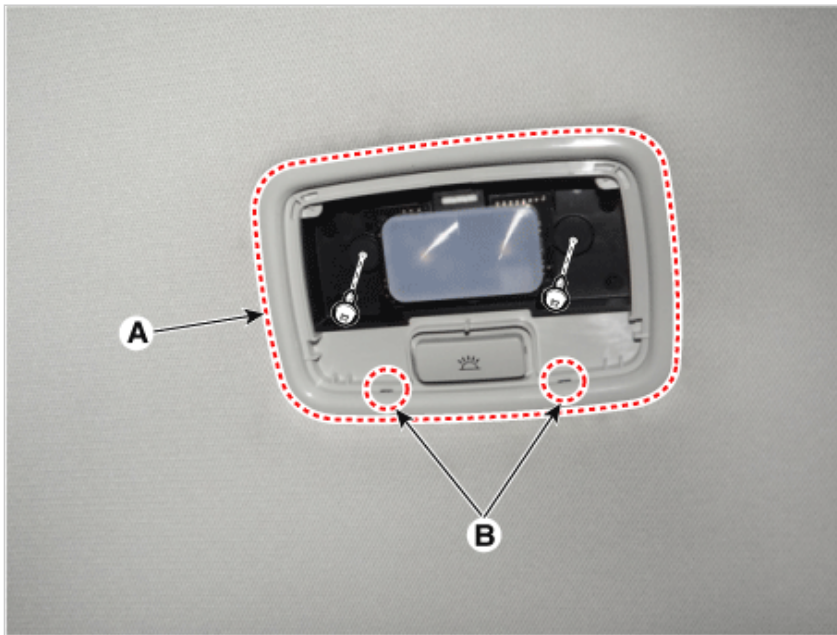

25. Remove the room lamp after disconnecting the connector (A).



26. Disconnect the roof trim main connectors (A) and the mounting clips in the front pillar.  
[Driver"s]





[Passenger"s]

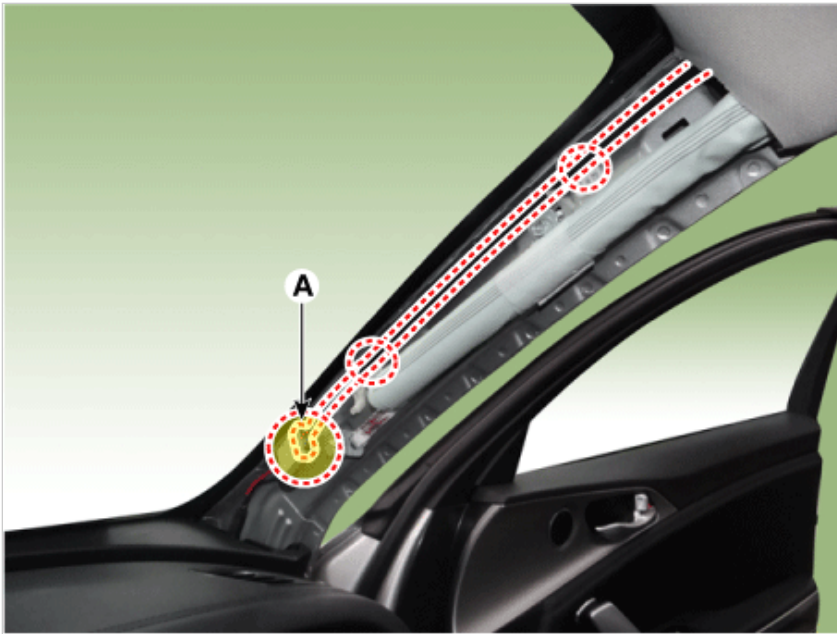

27. Disconnect the connectors (A) and the mounting clips in the rear pillar [RH].

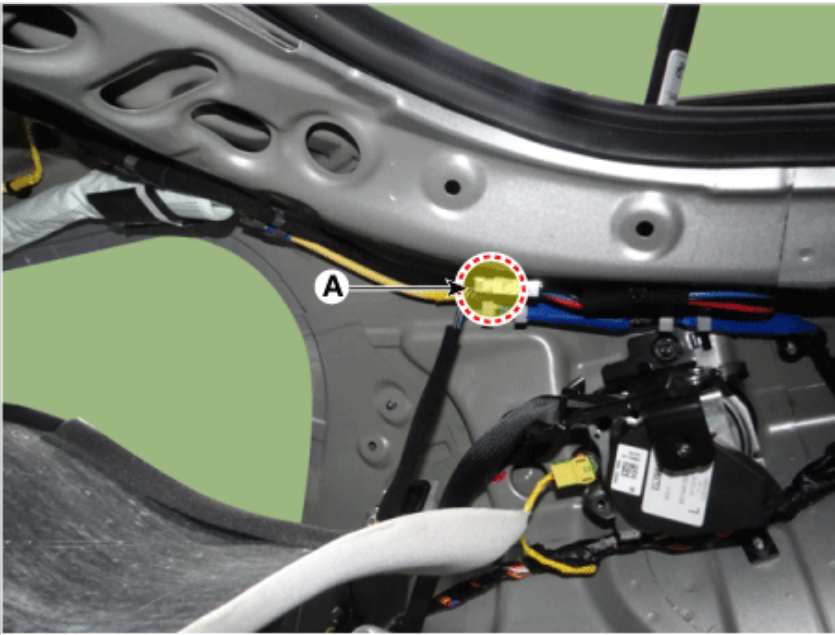

28. Remove the roof trim mounting clip and remove the roof trim assembly (A).

**NOTICE**

Be careful not to wrinkle on the roof trim.

[Front]



[Rear]

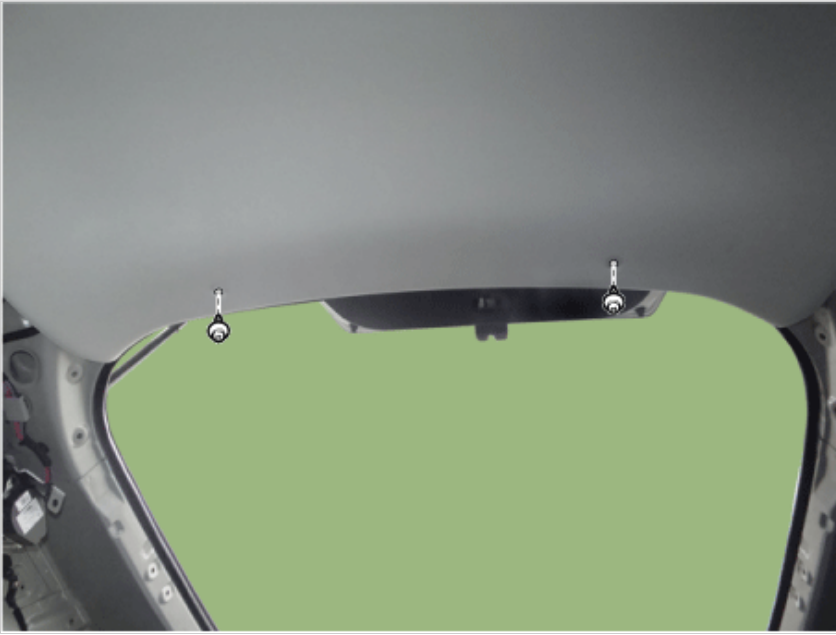

29. Remove the roof trim assembly (A) from the vehicle through the tail gate.

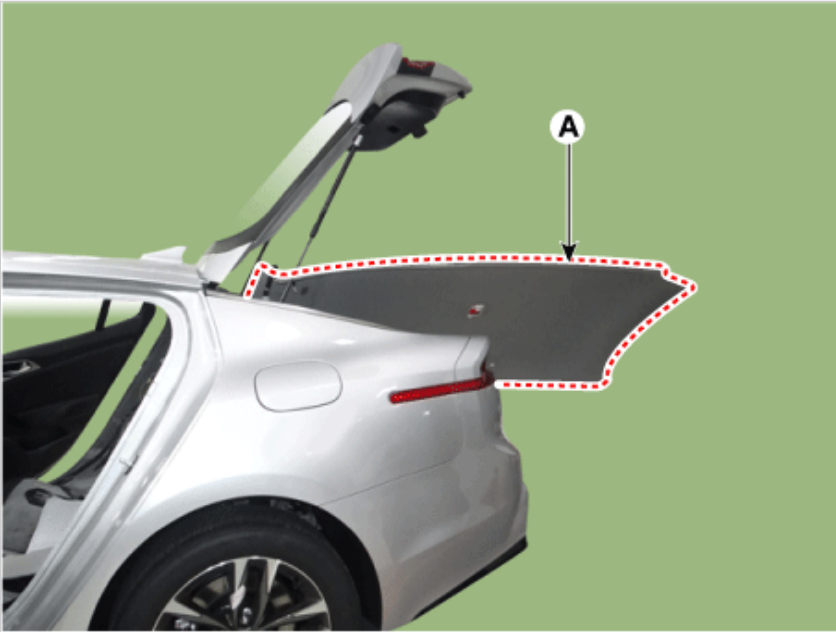

30. Remove the vanity lamp.

(Refer to Body Electrical System - "Vanity Lamp")

31. Remove roof trim wiring harness (A) from the roof trim (B).

#### NOTICE

Be careful not to damage the roof trim wiring harness (A) when removing.

32. Install in the reverse order of removal.



#### Information

- Make sure the connector is plugged in properly.
- Replace any damaged clips.